

### Industrial architecture

The PfiEFFwiesen plant at B. Braun in Melsungen achieved international recognition as an outstanding example of modern industrial architecture.

Designed by renowned architects James Stirling and Michael Wilford, this industrial building has already won several awards.

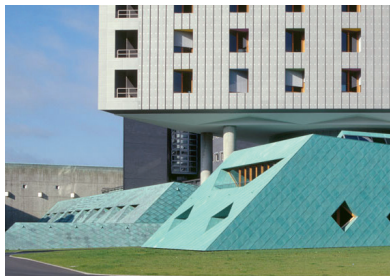

The PfiEFFwiesen plant presents itself as a synthesis of functionality and aesthetics and shows how nature and industrial construction can be combined successfully.

### The B. Braun art collection

At B. Braun, art is present in all areas: In offices, corridors, production halls and in the company restaurants.

More than 800 exhibits are a stimulating documentation of the work of artists from many countries, including participants from the documenta international exhibition in Kassel.



The artistic spectrum ranges

from innovative contemporary painting and photography to sculptures and video installations.

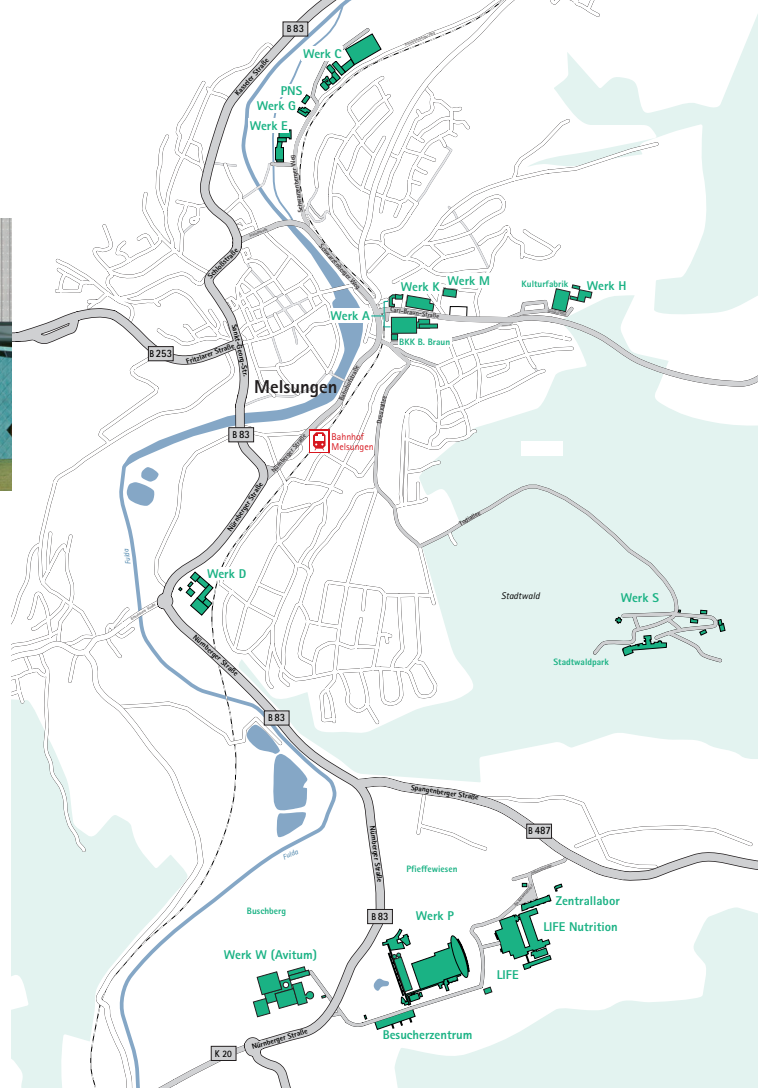

B. Braun Melsungen AG  
Werk P | PfiEFFwiesen | 34212 Melsungen  
GPS ► N: 51,1035°, O: 9,5484°

Registration under:  
E-Mail: [werkuehrungen@bbraun.com](mailto:werkuehrungen@bbraun.com)  
Tel 05661 71-5040

B. Braun SE | 34209 Melsungen | Germany  
[www.bbraun.com](http://www.bbraun.com)

**B. BRAUN**  
SHARING EXPERTISE

# Discover B. Braun

Factory tours at the  
Melsungen site



# Factory tours at the Melsungen site

Production facilities with different automation levels, a logistics organization that spans Europe, modern office landscapes supporting creative work, postmodern architecture in harmony with the north Hessian landscape—during factory tours at the Melsungen site, you will experience B. Braun and its progressive industrial culture from a variety of perspectives.

Around 10,000 guests visit the PfiEFFewiesen plant and other production facilities in Melsungen each year..

## Visitor center and production of infusion lines

During a tour of the Visitor Center, you will learn much about the B. Braun family business and its successful development, which has been guided by innovation for

more than 180 years. You can feel the closeness to production and experience how the latest technology and highly innovative products and services are created to improve the health of people around

the world with all your senses. You can also observe the manufacturing process of the Intrafix® IV sets through a glass visitor's walkway.



## Nutrition solutions production and central laboratory

The LIFE Nutrition plant develops and produces innovative nutrition solutions for the global market, results from developments in pharmaceutical research, sterilization, bag production and packaging research all flow



together here. Products for clinical nutrition such as amino acid solutions, carbohydrate solutions and fat emulsions are filled on two production lines. In the Central Laboratory, quality control and research & development has been merged into

a single unit to meet the high demands for quality and product development with state-of-the-art modular working technology.

## Infusion solutions production

B. Braun has been developing and manufacturing infusion solutions and setting standards in the use of plastic as a container material for over 70 years now. Our developments ensure a permanent increase in safety for users and patients. This tradition drives the success of the Ecoflac plus product, which is manufactured in Europe's most modern production facility for infusion solutions, LIFE.



## Dialysis machines and infusion pumps production

The W plant on the Buschberg site produces dialysis machines and state-of-the-art syringe and infusion pumps. A tour of the foyer provides information

about the innovative machines, their use and the complexity of the range. This ranges from training services and networking technology to the company's own dialysis stations.

## Central european distribution center

In the distribution center, finished goods are stored, picked and shipped to locations in Europe, and certain products are also sent to the rest of the world. On this tour you will gain insight into the entire logistics process—from the receipt of the goods to sterilization and storage in the high-bay warehouse.

